

REVISIONS				
ZONE	REV.	DESCRIPTION	DATE	APPROVED

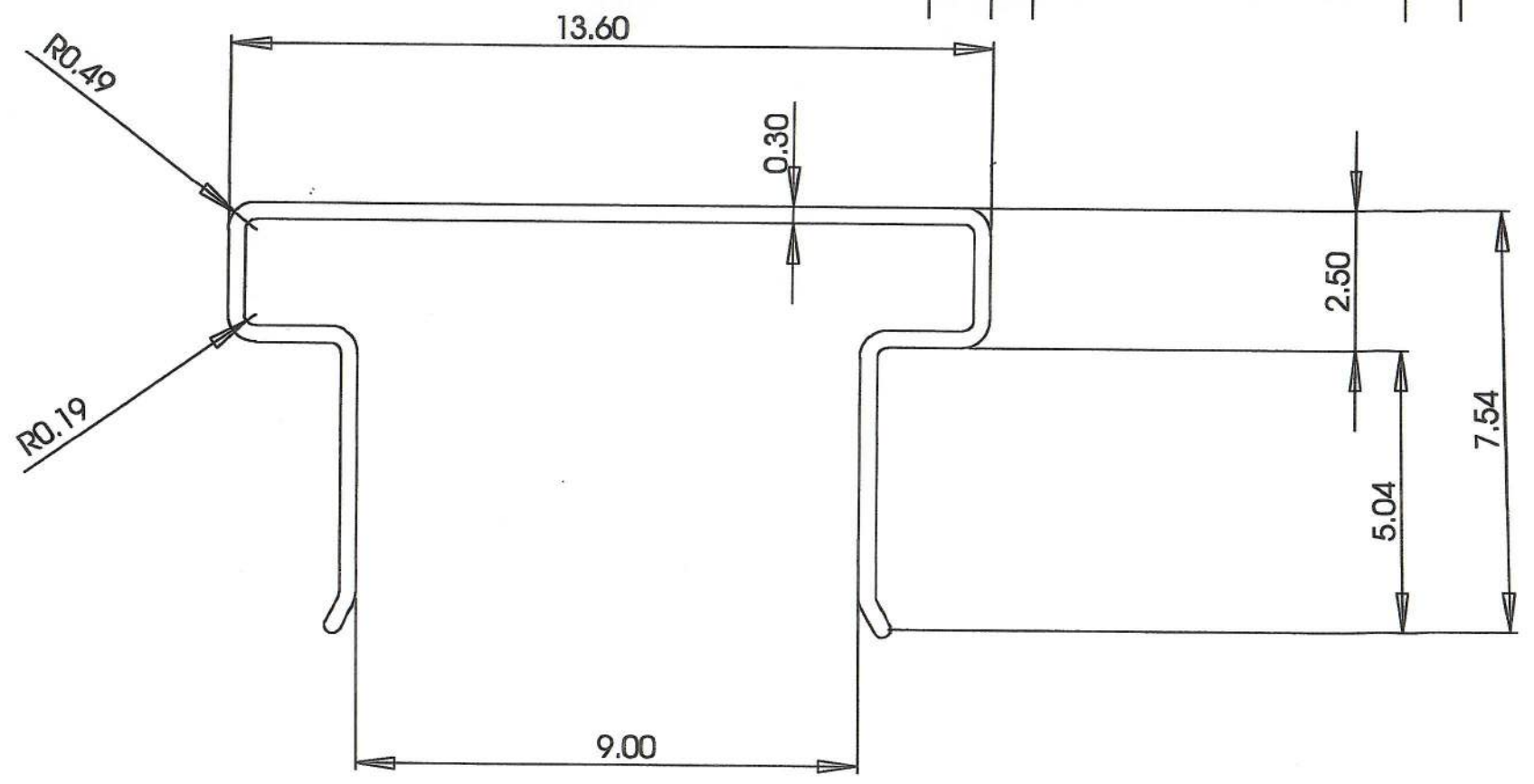

**SuperWall Fiberglass Top Cap
For 7.25" FRP sheetpile**

PROPRIETARY AND CONFIDENTIAL
THE INFORMATION CONTAINED IN THIS
DRAWING IS THE SOLE PROPERTY OF
DIVERSIFIED COMPOSITES INC. ANY
REPRODUCTION IN PART OR AS A WHOLE
WITHOUT THE WRITTEN PERMISSION OF
DIVERSIFIED COMPOSITES INC. IS
PROHIBITED.

LEE COMPOSITES, INC.
P. O. Box 130363
The Woodlands, Texas 77393-0363
(O) 281-376-6146 (M) 281-782-2477
Email: boblec@leecomposites.com